

LEGEND

- PERENNIAL STREAM CHANNEL (R3)
- INTERMITTENT STREAM CHANNEL (R4)
- EPHEMERAL STREAM CHANNEL (R6)
- PALUSTRINE FORESTED (PFO) WETLAND
- PALUSTRINE SCRUB-SHRUB (PSS) WETLAND
- PALUSTRINE EMERGENT (PEM) WETLAND
- PALUSTRINE OPEN WATER (POW) WETLAND
- PERMANENT IMPACTS - R4 STREAM CHANNEL
- PERMANENT IMPACTS - R6 STREAM CHANNEL
- TEMPORARY IMPACTS - R3 STREAM CHANNEL
- TEMPORARY IMPACTS - R4 STREAM CHANNEL
- PERMANENT IMPACTS - PFO WETLAND
- PERMANENT IMPACTS - PSS WETLAND
- PERMANENT IMPACTS - PEM WETLAND
- PERMANENT IMPACTS - POW WETLAND
- PERMANENT IMPACTS (CONVERSION TO PEM) - PFO WETLAND
- PROPOSED LIMITS OF DISTURBANCE
- PARCEL BOUNDARIES

*WATER FEATURES WERE DELINEATED BY ECS USING A SUB-METER ACCURACY GPS UNIT ON THE FOLLOWING DATES:

- MARCH 7, 2025
- MARCH 12, 2025
- MARCH 13, 2025

Impact ID	Duration	Cowardin	Linear Feet (LF)	Sq. Feet (SF)	Acres (AC)
Stream Impact 1	Temporary	R4	69	143	0.01
Stream Impact 2	Temporary	R4	71	143	0.01
Stream Impact 3	Temporary	R4	206	1,115	0.03
Stream Impact 4	Permanent	R6	128	256	0.01
Stream Impact 5	Permanent	R4	119	593	0.01
Stream Impact 6	Temporary	R3	28	223	0.01
Wetland Impact 1	Permanent (Conversion to PEM)	PFO	-	1,623	0.04
Wetland Impact 2	Permanent (Conversion to PEM)	PFO	-	2,749	0.06
Wetland Impact 3-1	Permanent	PFO	-	2,712	0.06
Wetland Impact 3-2	Permanent (Conversion to PEM)	PFO	-	8,748	0.20
Wetland Impact 4	Permanent	PFO	-	3,465	0.08
Wetland Impact 5	Permanent	POW	-	174	0.01
Wetland Impact 6	Permanent	PEM	-	914	0.02
Wetland Impact 7	Permanent	PSS	-	7,424	0.17
Wetland Impact 8	Permanent (Conversion to PEM)	PFO	-	2,679	0.06
Wetland Impact 9	Permanent (Conversion to PEM)	PFO	-	11,518	0.26
Total R3 Stream Impacts (Temporary)			28	223	0.01
Total R4 Stream Impacts (Permanent)			119	593	0.01
Total R4 Stream Impacts (Temporary)			346	1,401	0.03
Total R6 Stream Impacts (Permanent)			128	256	0.01
Total PFO Wetland Impacts (Permanent)			-	6,177	0.14
Total PFO Wetland Impacts (Conversion to PEM)			-	27,317	0.63
Total PSS Wetland Impacts (Permanent)			-	7,424	0.17
Total PEM Wetland Impacts (Permanent)			-	914	0.02
Total POW Wetland Impacts (Permanent)			-	174	0.01

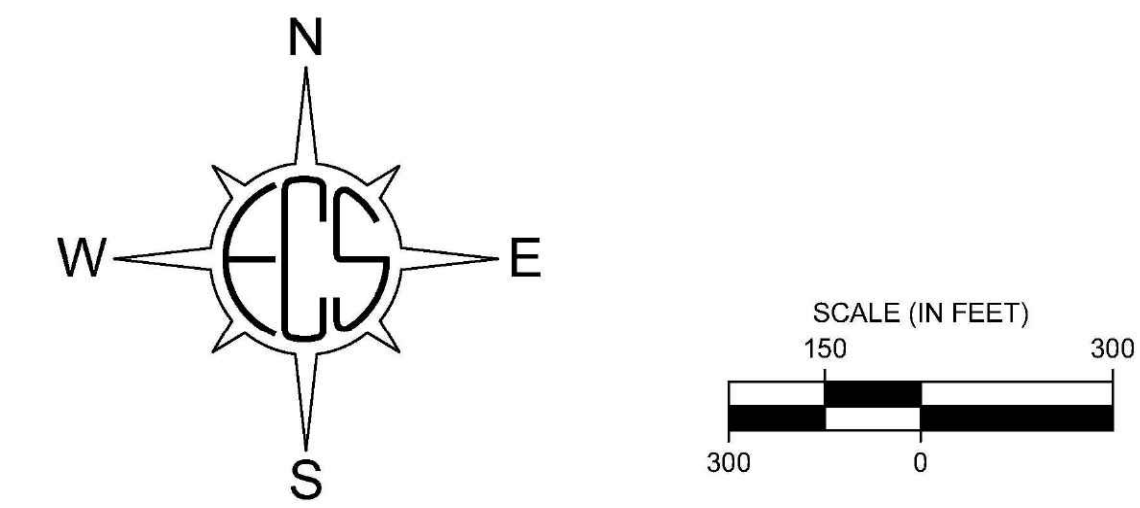



ROBERT W. PEAY
D.B. 89, PG. 731
GPN: 4-3-1

DBC PROPERTIES LLC
D.B. X, PG. X
GPN: 4-3-2

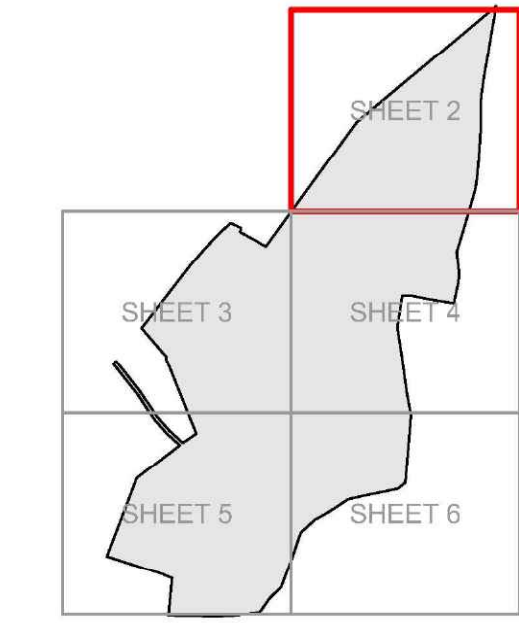

VICINITY MAP

1" = 2,000'

LEGEND

- PERENNIAL STREAM CHANNEL (R3)
- INTERMITTENT STREAM CHANNEL (R4)
- EPHEMERAL STREAM CHANNEL (R6)
- PALUSTRINE FORESTED (PFO) WETLAND
- PALUSTRINE SCRUB-SHRUB (PSS) WETLAND
- PALUSTRINE EMERGENT (PEM) WETLAND
- PALUSTRINE OPEN WATER (POW) WETLAND
- PERMANENT IMPACTS - R4 STREAM CHANNEL
- PERMANENT IMPACTS - R6 STREAM CHANNEL
- TEMPORARY IMPACTS - R3 STREAM CHANNEL
- TEMPORARY IMPACTS - R4 STREAM CHANNEL
- PERMANENT IMPACTS - PFO WETLAND
- PERMANENT IMPACTS - PSS WETLAND
- PERMANENT IMPACTS - PEM WETLAND
- PERMANENT IMPACTS - POW WETLAND
- PERMANENT IMPACTS (CONVERSION TO PEM) - PFO WETLAND
- PROPOSED LIMITS OF DISTURBANCE
- PARCEL BOUNDARIES

*WATER FEATURES WERE DELINEATED BY ECS USING A SUB-METER ACCURACY GPS UNIT ON THE FOLLOWING DATES:
 • MARCH 7, 2025
 • MARCH 12, 2025
 • MARCH 13, 2025

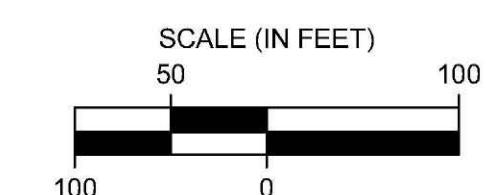
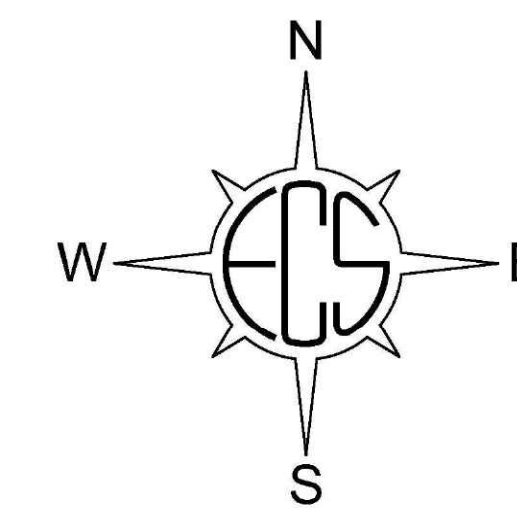

CELEBRATING
OVER 30 YEARS
OF EXCELLENCE

ECS - MD-ATLANTIC, LLC
1300 CHARWOOD ROAD
SUITE B
HANOVER, MD 21076
1-800-832-3489
410-869-4300
(FAX) 703-834-5827



**POINTONE DATA CENTER CAMPUS
ROXBURY ROAD
CHARLES CITY COUNTY, VIRGINIA**

**WATERS OF THE U.S.
IMPACT MAP
POINTONE, LLC**

ECS REVISIONS
TJW - 27 OCT 2025
TJW - 07 NOV 2025

ENGINEER: JMH
DRAFTING: TJW

SCALE: 1" = 100'

PROJECT NO.: 47-19067-F

SHEET: 2 OF 6

DATE: 23 SEP 2025

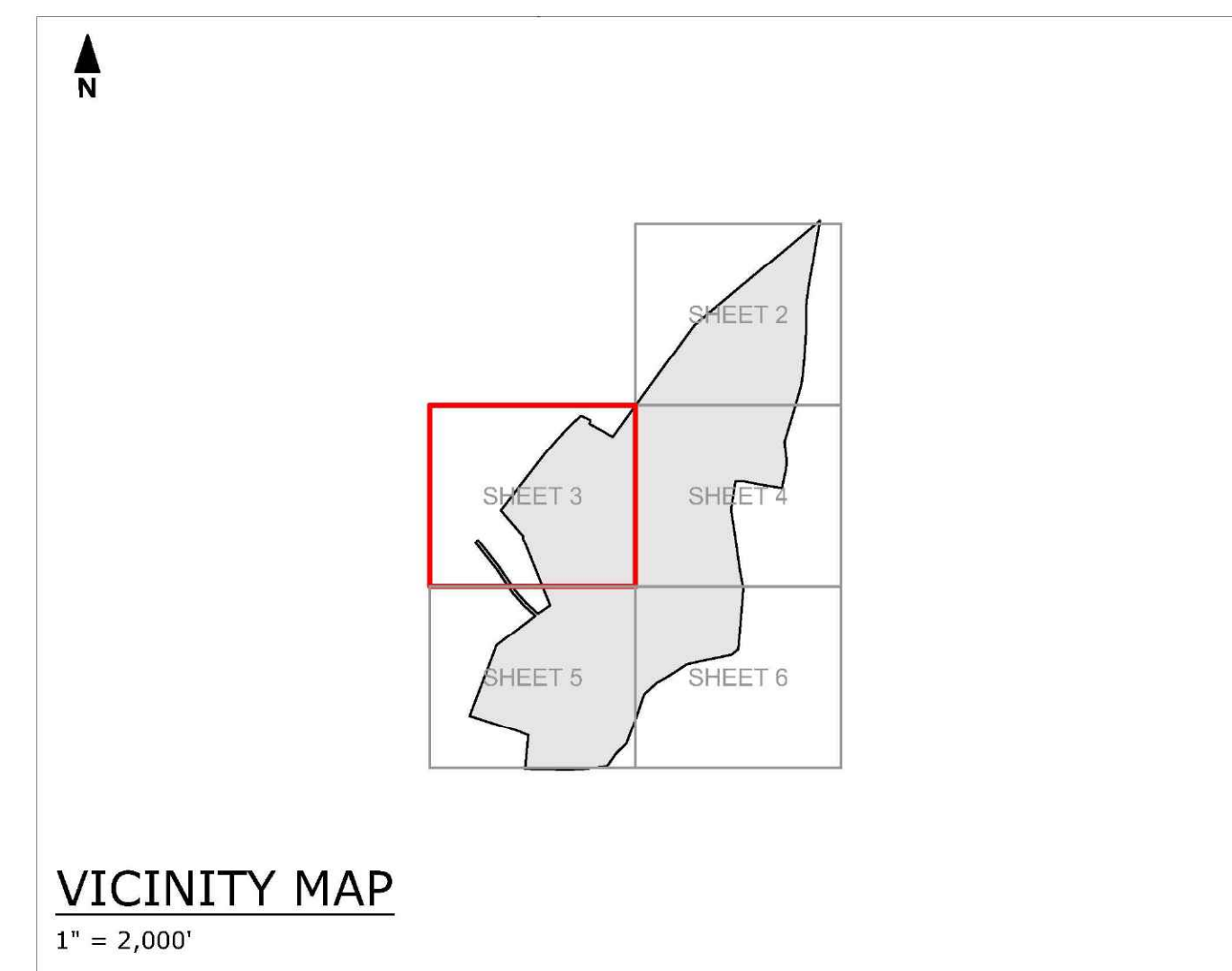

- LEGEND**
- PERENNIAL STREAM CHANNEL (R3)
 - INTERMITTENT STREAM CHANNEL (R4)
 - EPHEMERAL STREAM CHANNEL (R6)
 - PALUSTRINE FORESTED (PFO) WETLAND
 - PALUSTRINE SCRUB-SHRUB (PSS) WETLAND
 - PALUSTRINE EMERGENT (PEM) WETLAND
 - PALUSTRINE OPEN WATER (POW) WETLAND
 - PERMANENT IMPACTS - R4 STREAM CHANNEL
 - PERMANENT IMPACTS - R6 STREAM CHANNEL
 - TEMPORARY IMPACTS - R3 STREAM CHANNEL
 - TEMPORARY IMPACTS - R4 STREAM CHANNEL
 - PERMANENT IMPACTS - PFO WETLAND
 - PERMANENT IMPACTS - PSS WETLAND
 - PERMANENT IMPACTS - PEM WETLAND
 - PERMANENT IMPACTS - POW WETLAND
 - PERMANENT IMPACTS (CONVERSION TO PEM) - PFO WETLAND
 - PROPOSED LIMITS OF DISTURBANCE
 - PARCEL BOUNDARIES

*WATER FEATURES WERE DELINEATED BY ECS USING A SUB-METER ACCURACY GPS UNIT ON THE FOLLOWING DATES:

- MARCH 7, 2025
- MARCH 12, 2025
- MARCH 13, 2025

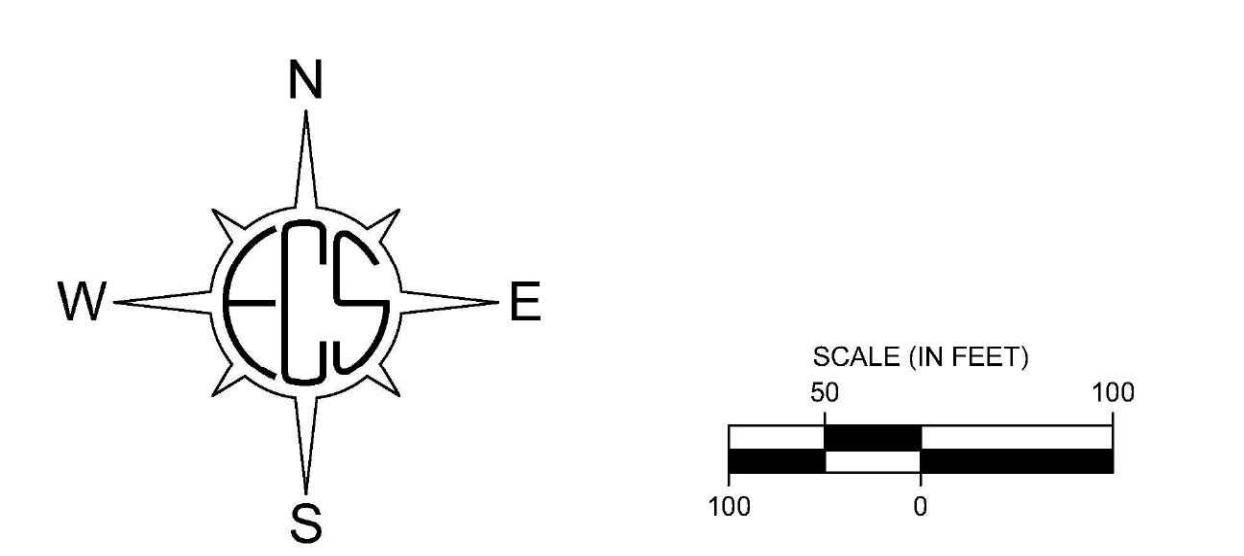

POINTONE DATA CENTER CAMPUS
ROXBURY ROAD
CHARLES CITY COUNTY, VIRGINIA

WATERS OF THE U.S.
IMPACT MAP
POINTONE, LLC

ECS REVISIONS
TJW - 27 OCT 2025
TJW - 07 NOV 2025

ENGINEER JM	DRAFTING TJW
SCALE 1" = 100'	
PROJECT NO. 47-19067-F	
SHEET 3 OF 6	
DATE 23 SEP 2025	

ECS - MD-ATLANTIC, LLC
1300 CHARWOOD ROAD
SUITE B
HANOVER, MD 21076
1-800-832-3489
410-859-4300
(FAX) 703-834-5827

CELEBRATING
OVER 30 YEARS
OF EXCELLENCE

“SETTING THE STANDARD FOR SERVICE”

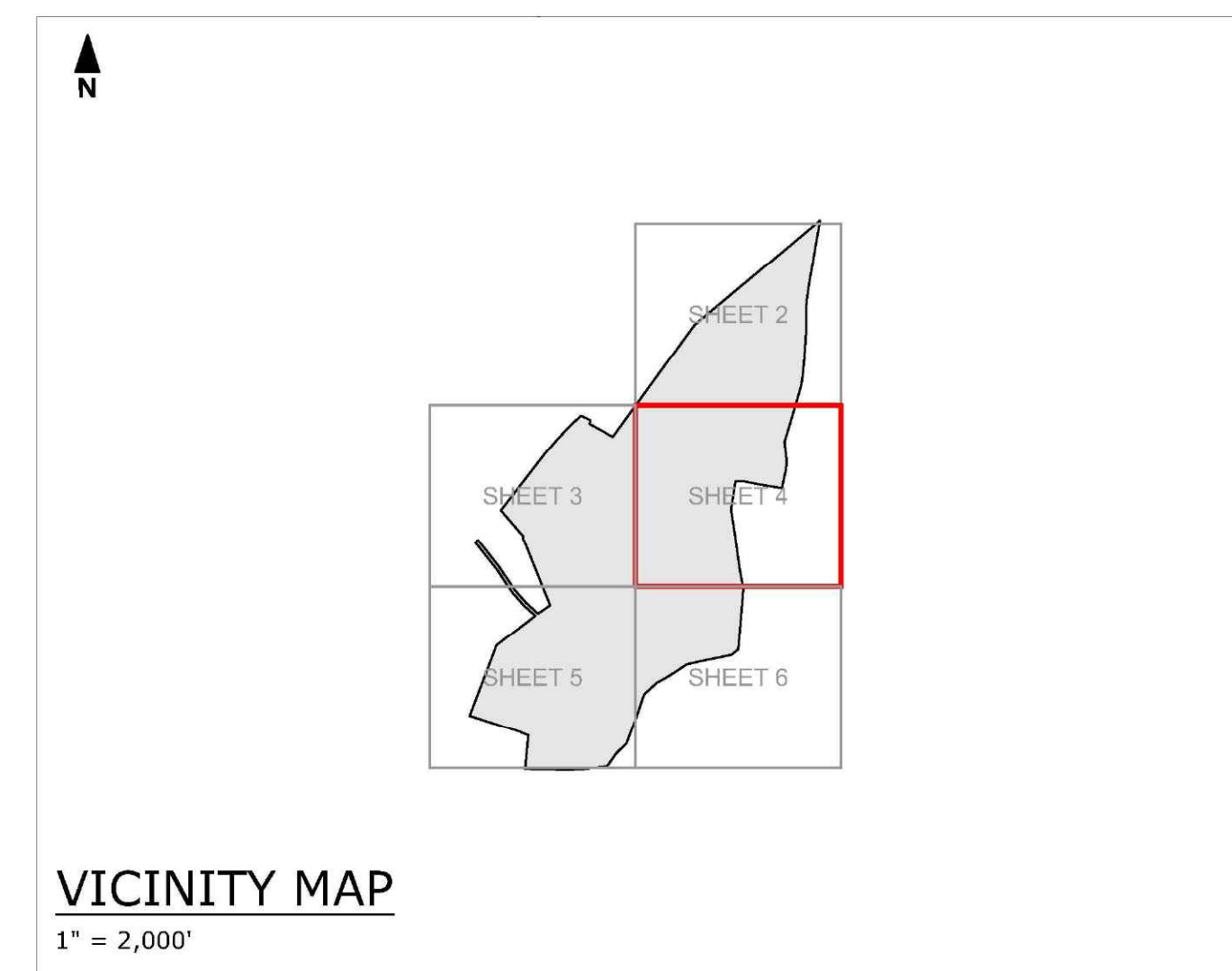
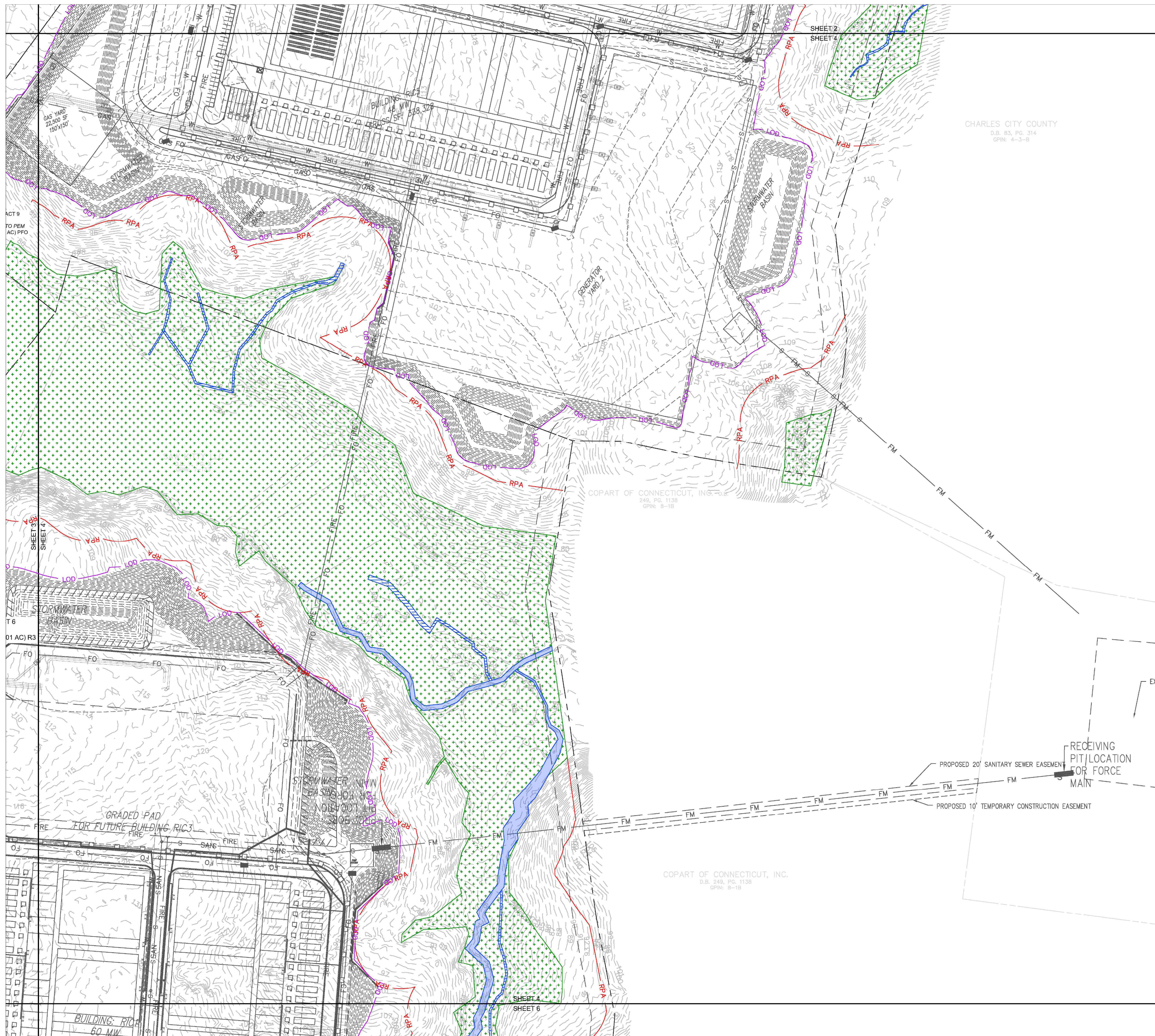

- LEGEND**
- PERENNIAL STREAM CHANNEL (R3)
 - INTERMITTENT STREAM CHANNEL (R4)
 - EPHEMERAL STREAM CHANNEL (R6)
 - PALUSTRINE FORESTED (PFO) WETLAND
 - PALUSTRINE SCRUB-SHRUB (PSS) WETLAND
 - PALUSTRINE EMERGENT (PEM) WETLAND
 - PALUSTRINE OPEN WATER (POW) WETLAND
 - PERMANENT IMPACTS - R4 STREAM CHANNEL
 - PERMANENT IMPACTS - R6 STREAM CHANNEL
 - TEMPORARY IMPACTS - R3 STREAM CHANNEL
 - TEMPORARY IMPACTS - R4 STREAM CHANNEL
 - PERMANENT IMPACTS - PFO WETLAND
 - PERMANENT IMPACTS - PSS WETLAND
 - PERMANENT IMPACTS - PEM WETLAND
 - PERMANENT IMPACTS - POW WETLAND
 - PERMANENT IMPACTS (CONVERSION TO PEM) - PFO WETLAND
 - PROPOSED LIMITS OF DISTURBANCE (LOD)
 - PARCEL BOUNDARIES

*WATER FEATURES WERE DELINEATED BY ECS USING A SUB-METER ACCURACY GPS UNIT ON THE FOLLOWING DATES:

- MARCH 7, 2025
- MARCH 12, 2025
- MARCH 13, 2025

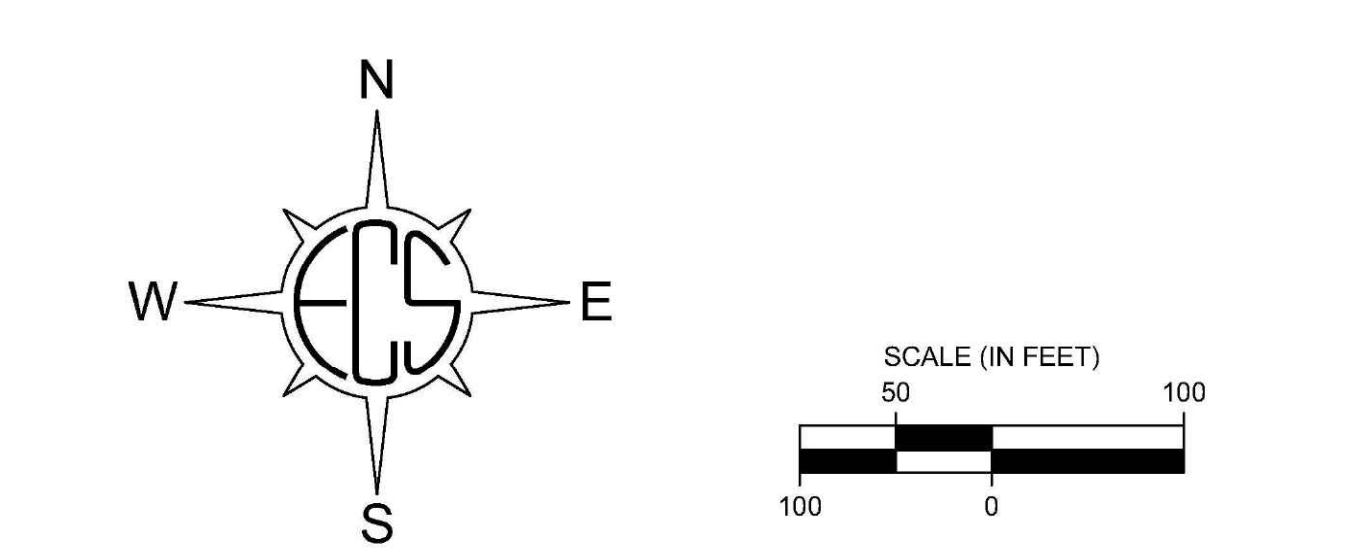

CELEBRATING
OVER 30 YEARS
OF EXCELLENCE

ECS - MID-ATLANTIC, LLC
1340 CHARWOOD ROAD
SUITE B
HANOVER, MD 21076
1-800-832-3489
410-869-4300
(FAX) 703-834-5827

"SETTING THE STANDARD FOR SERVICE"

POINTONE DATA CENTER CAMPUS
ROXBURY ROAD
CHARLES CITY COUNTY, VIRGINIA

WATERS OF THE U.S.
IMPACT MAP
POINTONE, LLC

ECS REVISIONS

TJW - 27 OCT 2025

TJW - 07 NOV 2025

ENGINEER	DRAFTING
JMH	TJW
SCALE 1" = 100'	
PROJECT NO. 47:19067-F	
SHEET 4 OF 6	
DATE 23 SEP 2025	

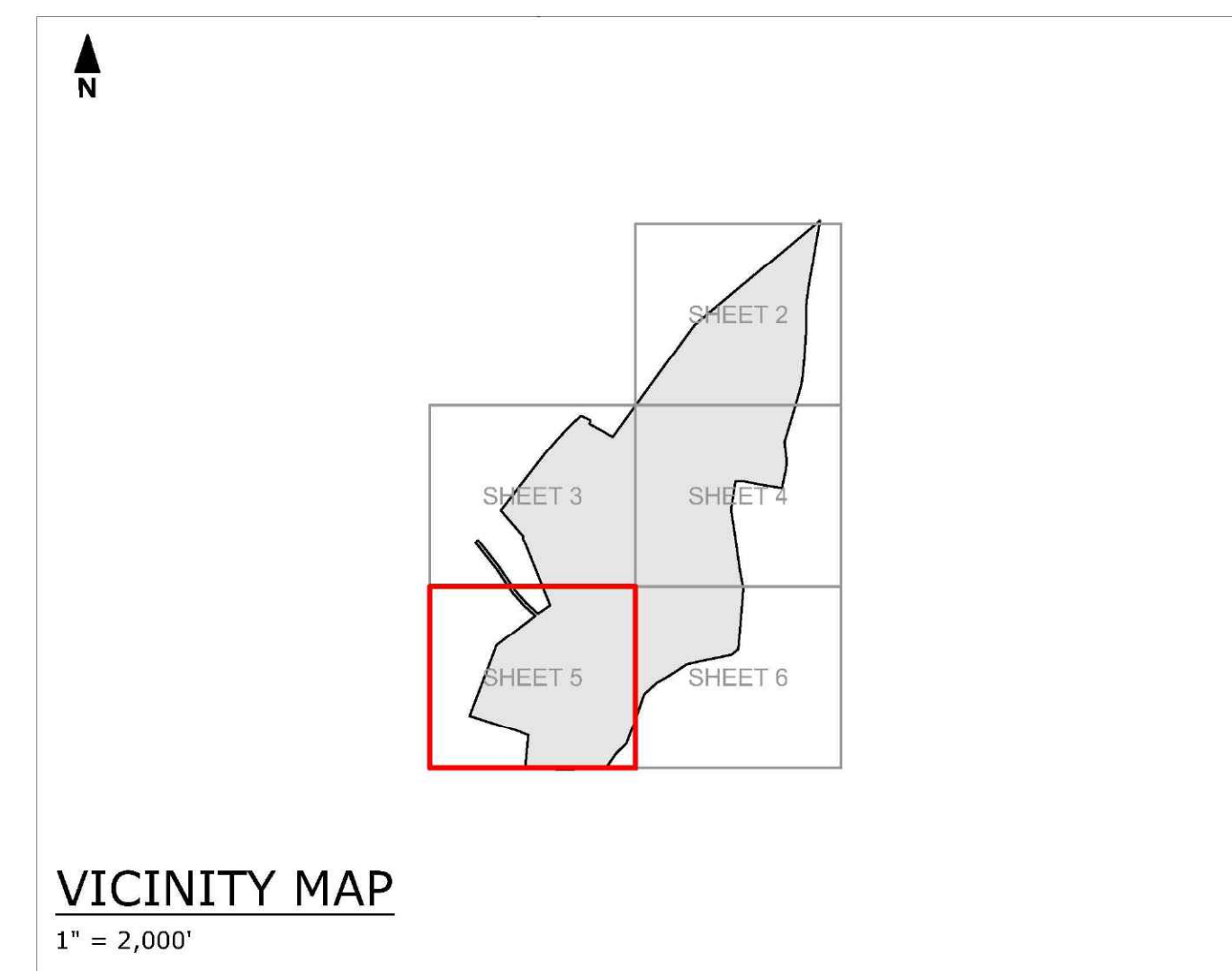
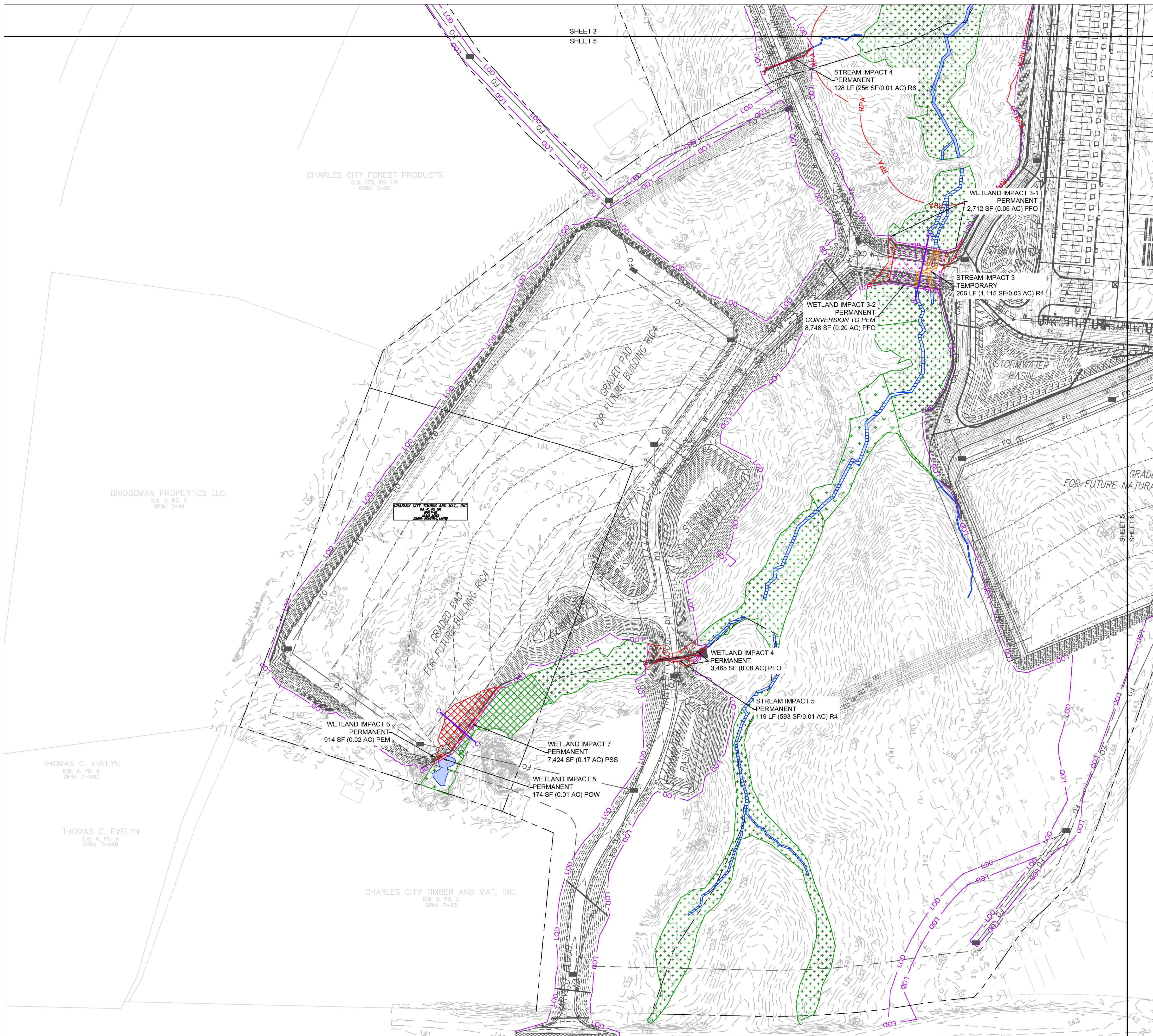

- LEGEND**
- PERENNIAL STREAM CHANNEL (R3)
 - INTERMITTENT STREAM CHANNEL (R4)
 - EPHEMERAL STREAM CHANNEL (R6)
 - PALUSTRINE FORESTED (PFO) WETLAND
 - PALUSTRINE SCRUB-SHRUB (PSS) WETLAND
 - PALUSTRINE EMERGENT (PEM) WETLAND
 - PALUSTRINE OPEN WATER (POW) WETLAND
 - PERMANENT IMPACTS - R4 STREAM CHANNEL
 - PERMANENT IMPACTS - R6 STREAM CHANNEL
 - TEMPORARY IMPACTS - R3 STREAM CHANNEL
 - TEMPORARY IMPACTS - R4 STREAM CHANNEL
 - PERMANENT IMPACTS - PFO WETLAND
 - PERMANENT IMPACTS - PSS WETLAND
 - PERMANENT IMPACTS - PEM WETLAND
 - PERMANENT IMPACTS - POW WETLAND
 - PERMANENT IMPACTS (CONVERSION TO PEM) - PFO WETLAND
 - PROPOSED LIMITS OF DISTURBANCE
 - PARCEL BOUNDARIES

*WATER FEATURES WERE DELINEATED BY ECS USING A SUB-METER ACCURACY GPS UNIT ON THE FOLLOWING DATES:

- MARCH 7, 2025
- MARCH 12, 2025
- MARCH 13, 2025

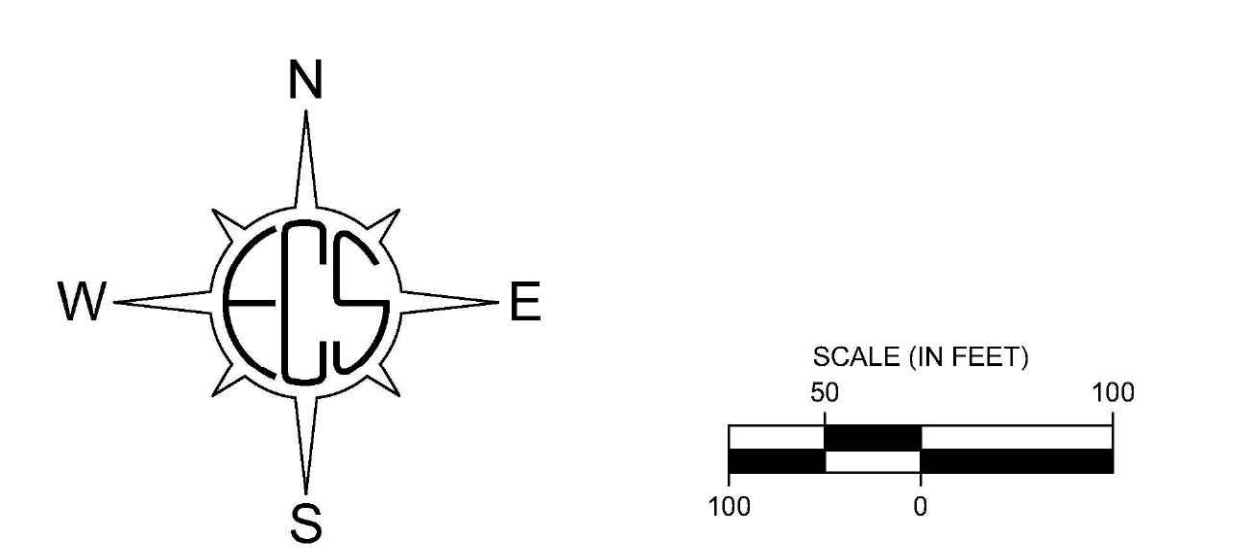

CELEBRATING
OVER 30 YEARS
OF EXCELLENCE

ECS - MD-ATLANTIC, LLC
1340 CHARWOOD ROAD
SUITE B
HANOVER, MD 21076
1-800-832-3489
410-869-4300
(FAX) 703-834-5827

"SETTING THE STANDARD FOR SERVICE"

POINTONE DATA CENTER CAMPUS
ROXBURY ROAD
CHARLES CITY COUNTY, VIRGINIA

POINTONE, LLC

WATERS OF THE U.S.
IMPACT MAP

ECS REVISIONS

TJW	- 27 OCT 2025
TJW	- 07 NOV 2025

ENGINEER
JMH

DRAFTING
TJW

SCALE
1" = 100'

PROJECT NO.
47:19067-F

SHEET
5 OF 6

DATE
23 SEP 2025

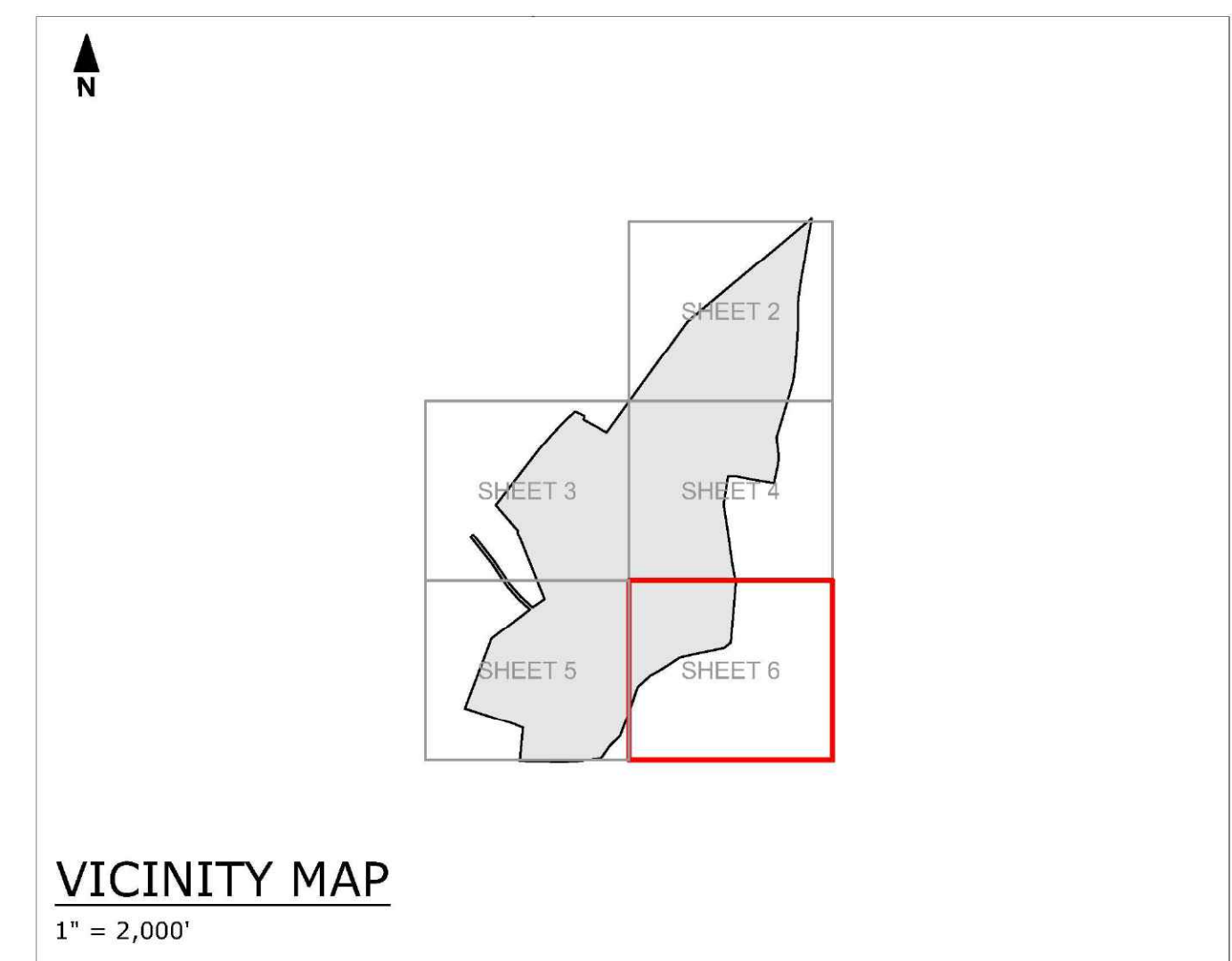
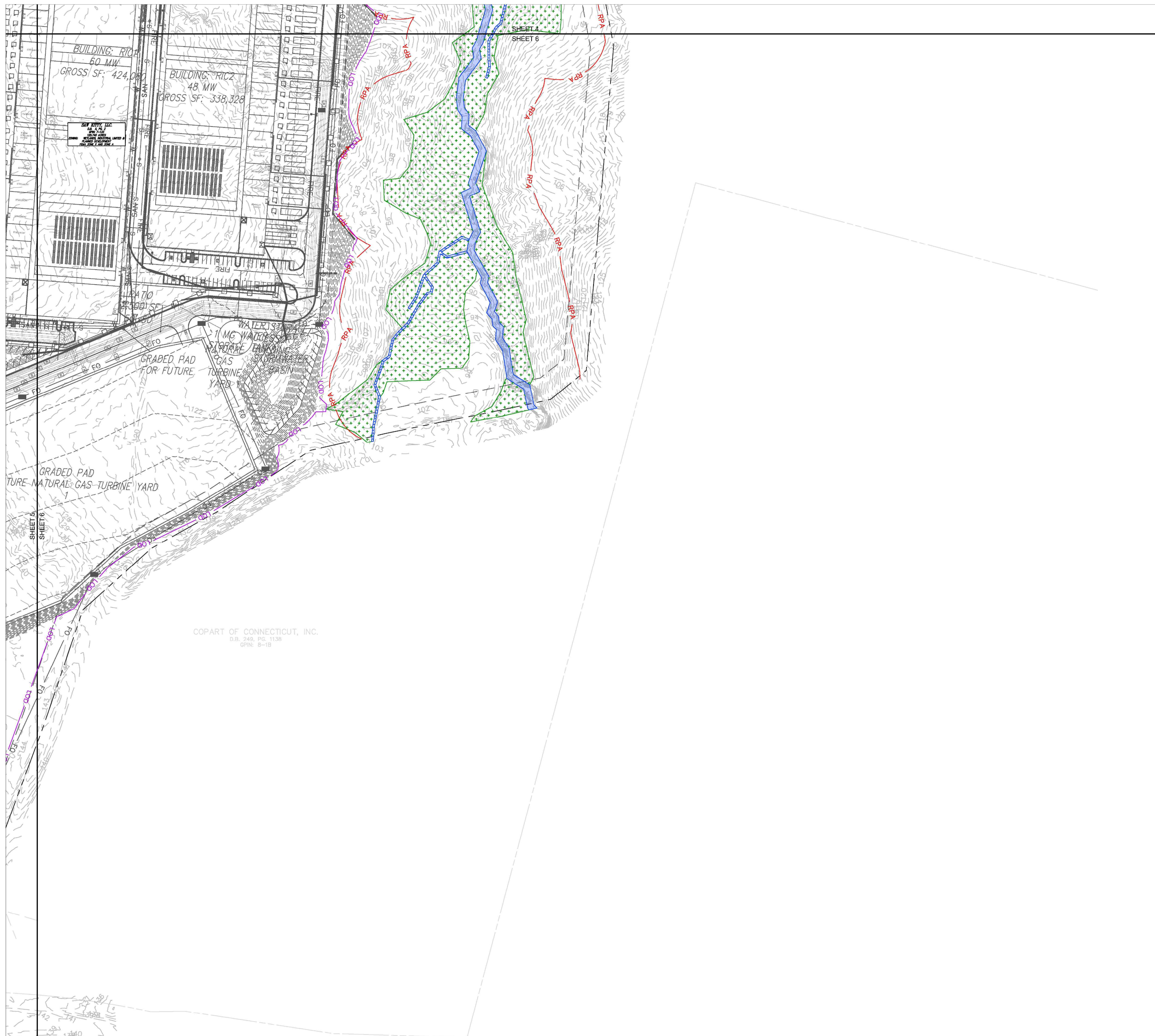

- LEGEND**
- PERENNIAL STREAM CHANNEL (R3)
 - INTERMITTENT STREAM CHANNEL (R4)
 - EPHEMERAL STREAM CHANNEL (R6)
 - PALUSTRINE FORESTED (PFO) WETLAND
 - PALUSTRINE SCRUB-SHRUB (PSS) WETLAND
 - PALUSTRINE EMERGENT (PEM) WETLAND
 - PALUSTRINE OPEN WATER (POW) WETLAND
 - PERMANENT IMPACTS - R4 STREAM CHANNEL
 - PERMANENT IMPACTS - R6 STREAM CHANNEL
 - TEMPORARY IMPACTS - R3 STREAM CHANNEL
 - TEMPORARY IMPACTS - R4 STREAM CHANNEL
 - PERMANENT IMPACTS - PFO WETLAND
 - PERMANENT IMPACTS - PSS WETLAND
 - PERMANENT IMPACTS - PEM WETLAND
 - PERMANENT IMPACTS - POW WETLAND
 - PERMANENT IMPACTS (CONVERSION TO PEM) - PFO WETLAND
 - PROPOSED LIMITS OF DISTURBANCE (LOD)
 - PARCEL BOUNDARIES
- *WATER FEATURES WERE DELINEATED BY ECS USING A SUB-METER ACCURACY GPS UNIT ON THE FOLLOWING DATES:
- MARCH 7, 2025
 - MARCH 12, 2025
 - MARCH 13, 2025

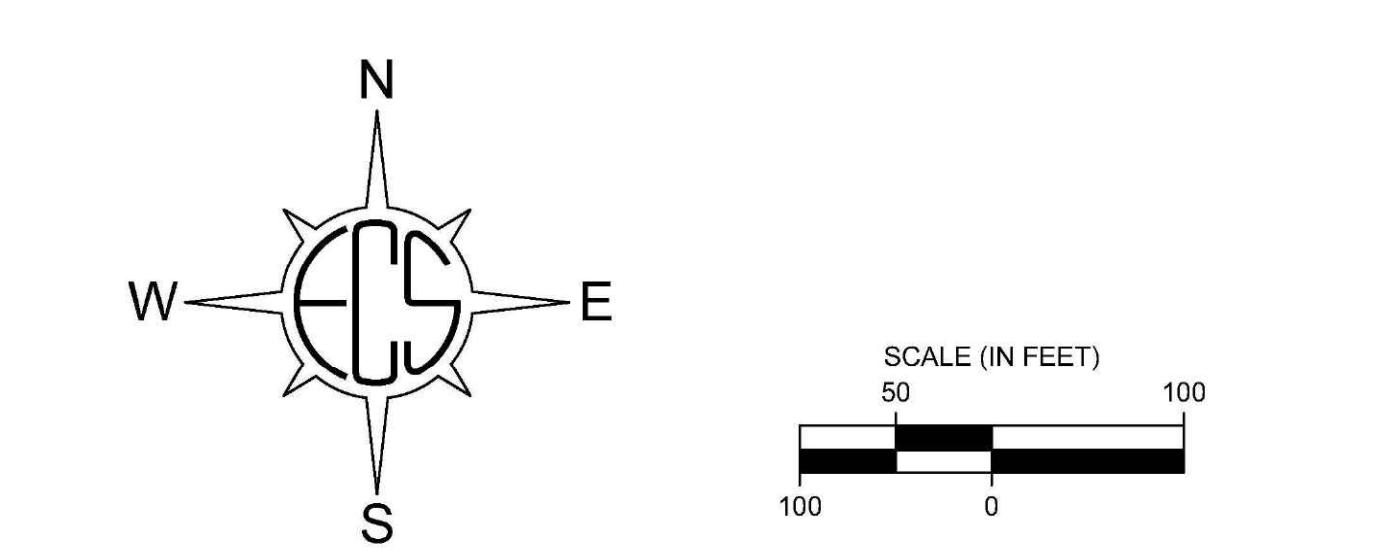

CELEBRATING
OVER 30 YEARS
OF EXCELLENCE

ECS - MD-ATLANTIC, LLC
1300 CHARWOOD ROAD
SUITE B
HANOVER, MD 21076
1-800-832-3489
410-869-4300
(FAX) 703-834-5827

"SETTING THE STANDARD FOR SERVICE"

POINTONE DATA CENTER CAMPUS
ROXBURY ROAD
CHARLES CITY COUNTY, VIRGINIA

WATERS OF THE U.S.
IMPACT MAP

POINTONE, LLC

ECS REVISIONS	
TJW - 27 OCT 2025	
TJW - 07 NOV 2025	
ENGINEER	DRAFTING
JMH	TJW
SCALE	1" = 100'
PROJECT NO.	47:19067-F
SHEET	6 OF 6
DATE	23 SEP 2025

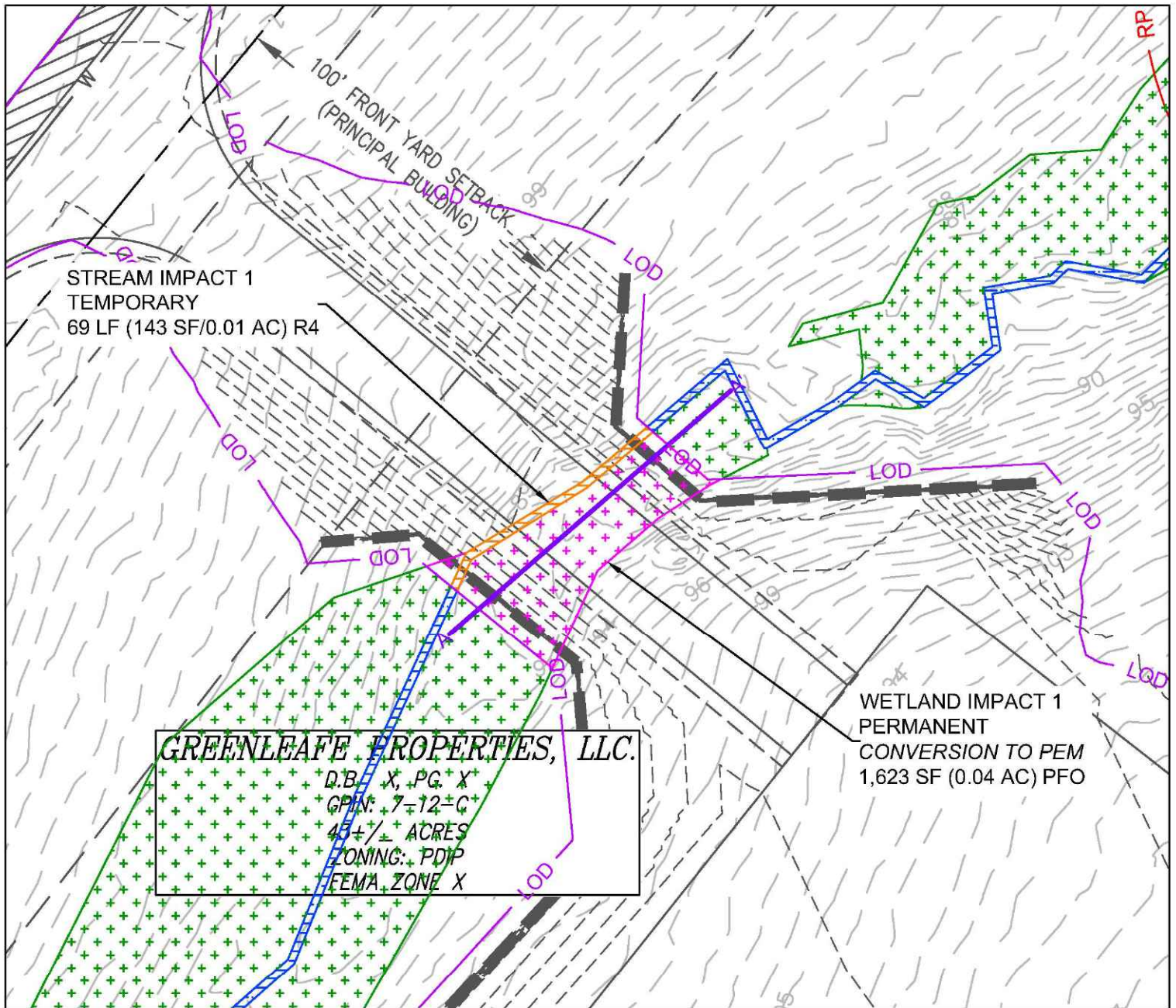

SCALE (IN FEET)

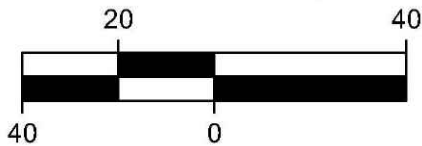

PERMIT APPLICATION
POINTONE DATA CENTER
CAMPUS
CHARLES CITY COUNTY,
VIRGINIA

SEPTEMBER 2025



1340 CHARWOOD ROAD, SUITE B
HANOVER, MARYLAND 21076
410-859-4300

PLAN VIEW
STREAM IMPACT 1
WETLAND IMPACT 1
WATERS OF THE U.S.

ECS PROJECT NO.
47:19067-F

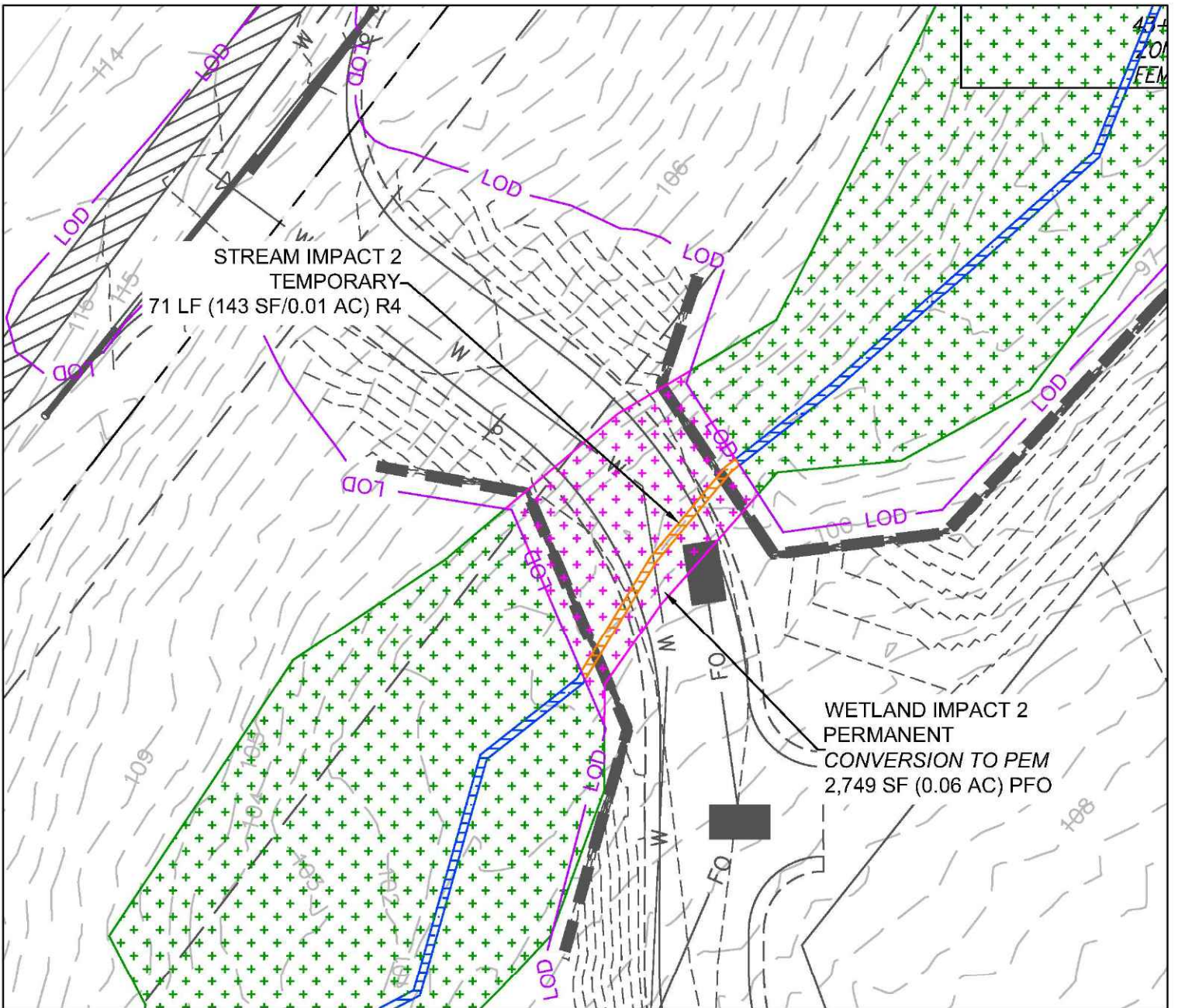

PERMIT APPLICATION
POINTONE DATA CENTER
CAMPUS
CHARLES CITY COUNTY,
VIRGINIA
SEPTEMBER 2025



1340 CHARWOOD ROAD, SUITE B
HANOVER, MARYLAND 21076
410-859-4300

PLAN VIEW
STREAM IMPACT 2
WETLAND IMPACT 2
WATERS OF THE U.S.
ECS PROJECT NO.
47:19067-F

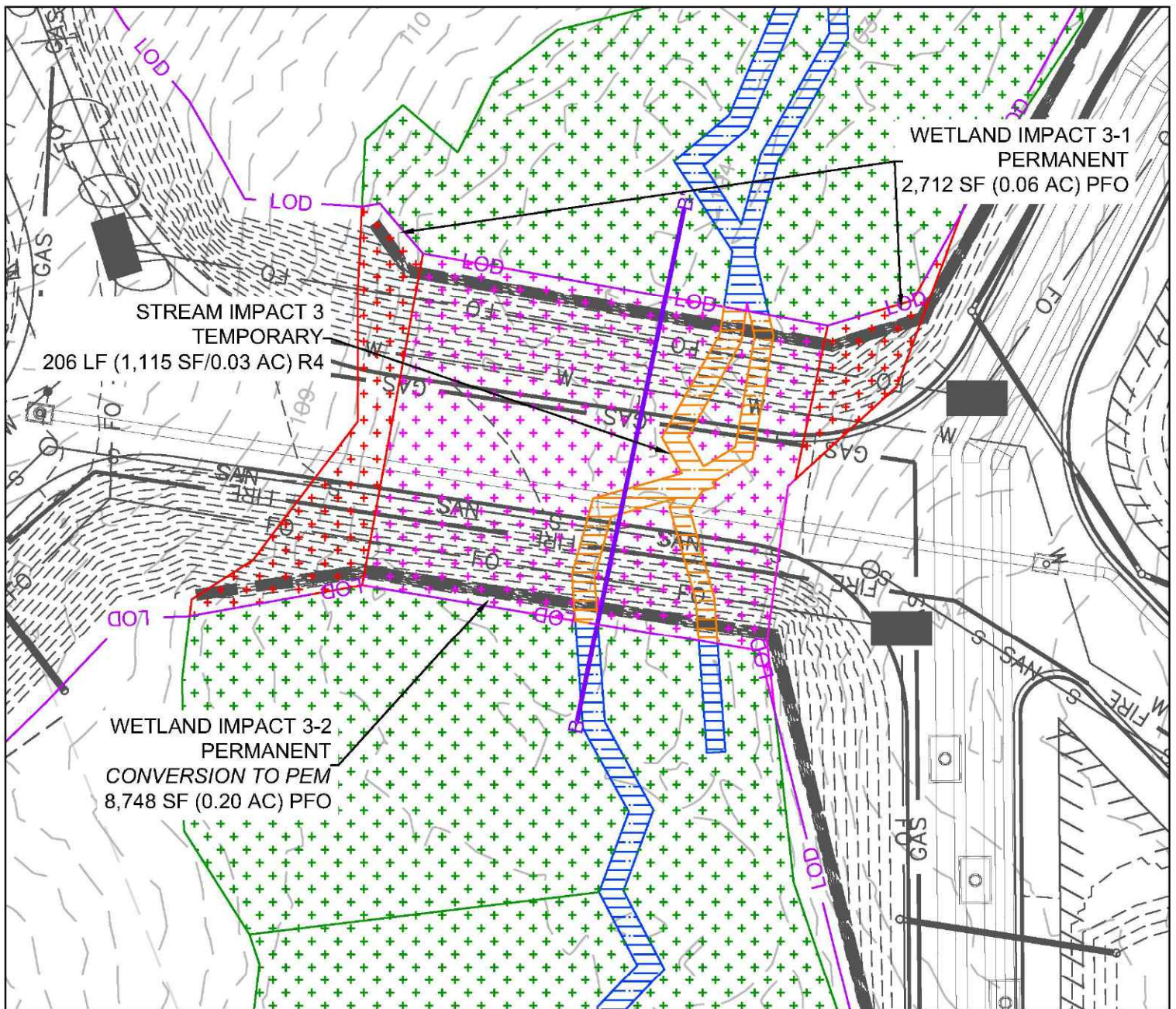

SCALE (IN FEET)

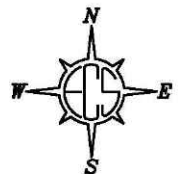
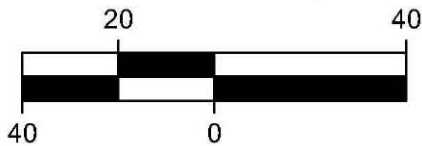

PERMIT APPLICATION
 POINTONE DATA CENTER
 CAMPUS
 CHARLES CITY COUNTY,
 VIRGINIA

SEPTEMBER 2025



1340 CHARWOOD ROAD, SUITE B
 HANOVER, MARYLAND 21076
 410-859-4300

PLAN VIEW
 STREAM IMPACT 3
 WETLAND IMPACT 3
 WATERS OF THE U.S.

ECS PROJECT NO.
 47:19067-F

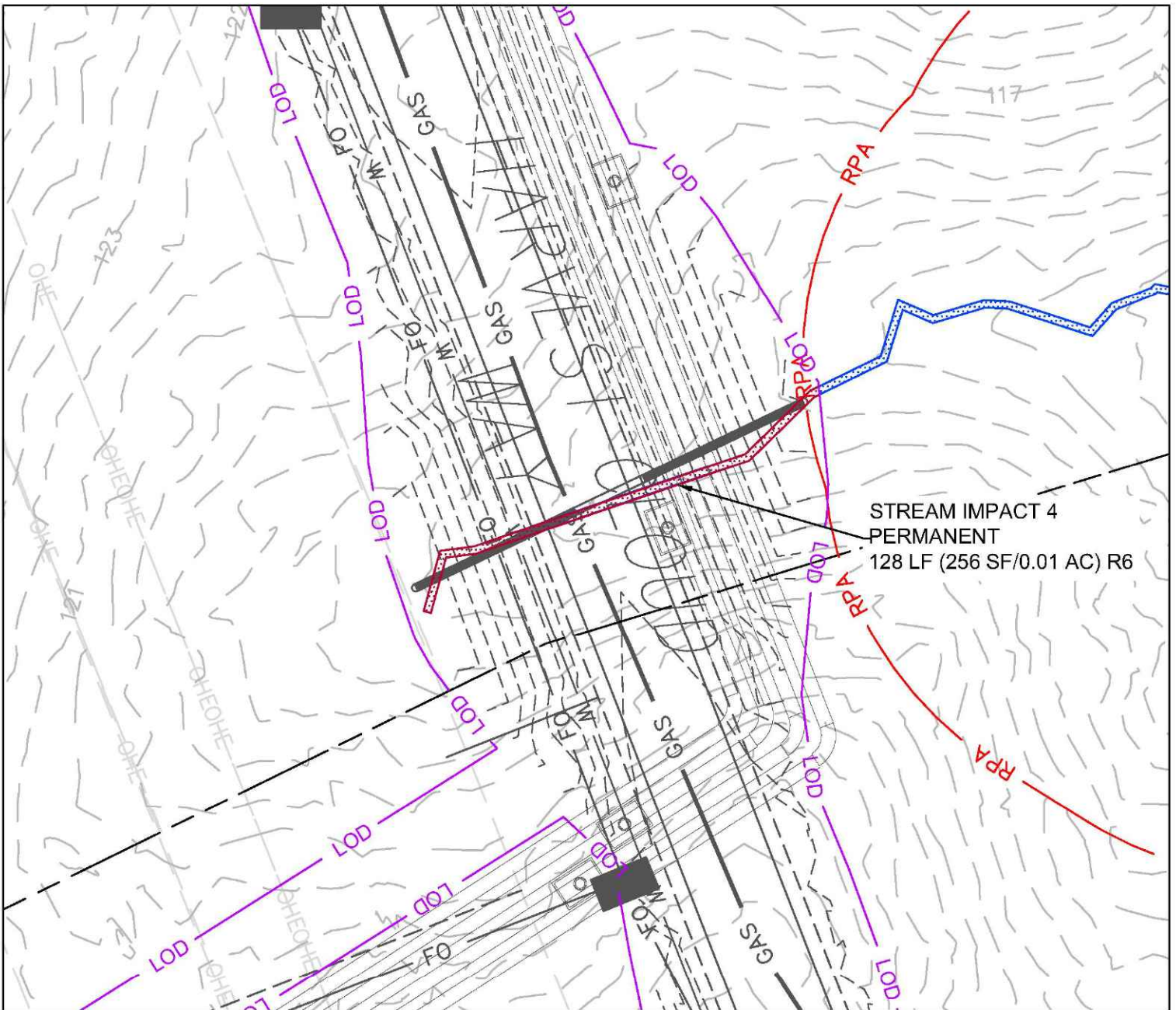

STREAM IMPACT 4
 PERMANENT
 128 LF (256 SF/0.01 AC) R6

SCALE (IN FEET)

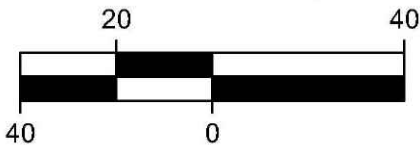

PERMIT APPLICATION
 POINTONE DATA CENTER
 CAMPUS
 CHARLES CITY COUNTY,
 VIRGINIA
 SEPTEMBER 2025



1340 CHARWOOD ROAD, SUITE B
 HANOVER, MARYLAND 21076
 410-859-4300

PLAN VIEW
 STREAM IMPACT 4
 WATERS OF THE U.S.

ECS PROJECT NO.
 47:19067-F

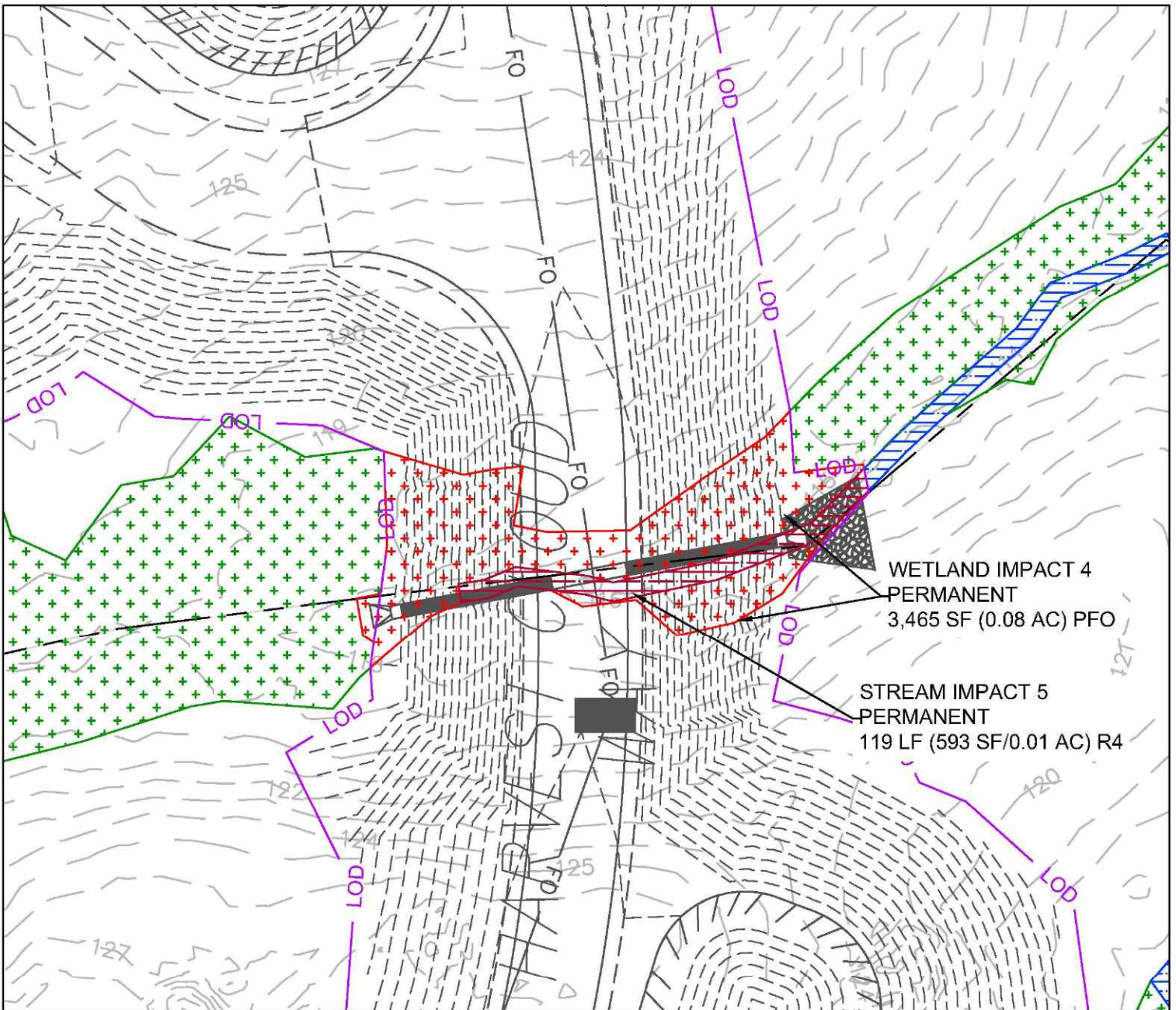

WETLAND IMPACT 4
 PERMANENT
 3,465 SF (0.08 AC) PFO

STREAM IMPACT 5
 PERMANENT
 119 LF (593 SF/0.01 AC) R4

SCALE (IN FEET)

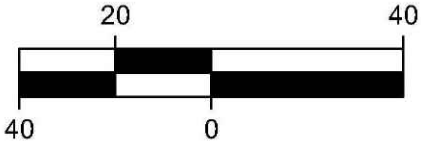

PERMIT APPLICATION
 POINTONE DATA CENTER
 CAMPUS
 CHARLES CITY COUNTY,
 VIRGINIA
 SEPTEMBER 2025



1340 CHARWOOD ROAD, SUITE B
 HANOVER, MARYLAND 21076
 410-859-4300

PLAN VIEW
 STREAM IMPACT 5
 WETLAND IMPACT 4
 WATERS OF THE U.S.
 ECS PROJECT NO.
 47:19067-F

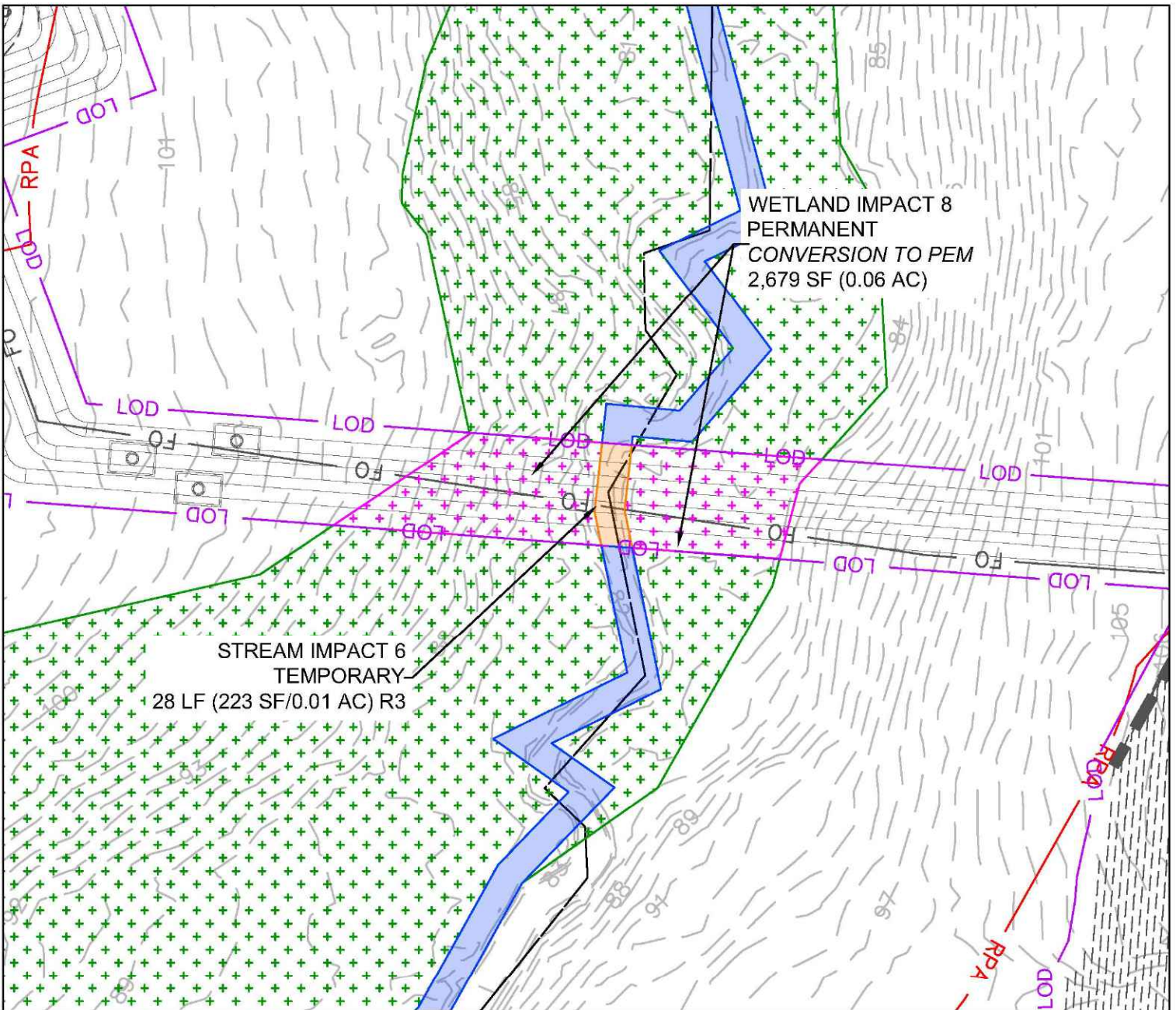

SCALE (IN FEET)

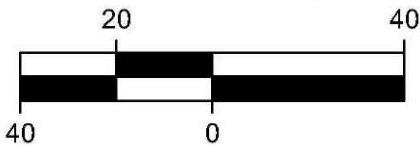

PERMIT APPLICATION
 POINTONE DATA CENTER
 CAMPUS
 CHARLES CITY COUNTY,
 VIRGINIA
 SEPTEMBER 2025



1340 CHARWOOD ROAD, SUITE B
 HANOVER, MARYLAND 21076
 410-859-4300

PLAN VIEW
 STREAM IMPACT 6
 WETLAND IMPACT 8
 WATERS OF THE U.S.

ECS PROJECT NO.
 47:19067-F

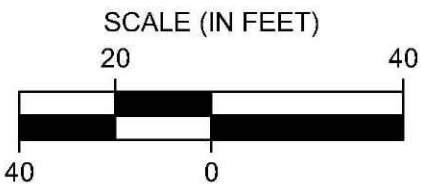
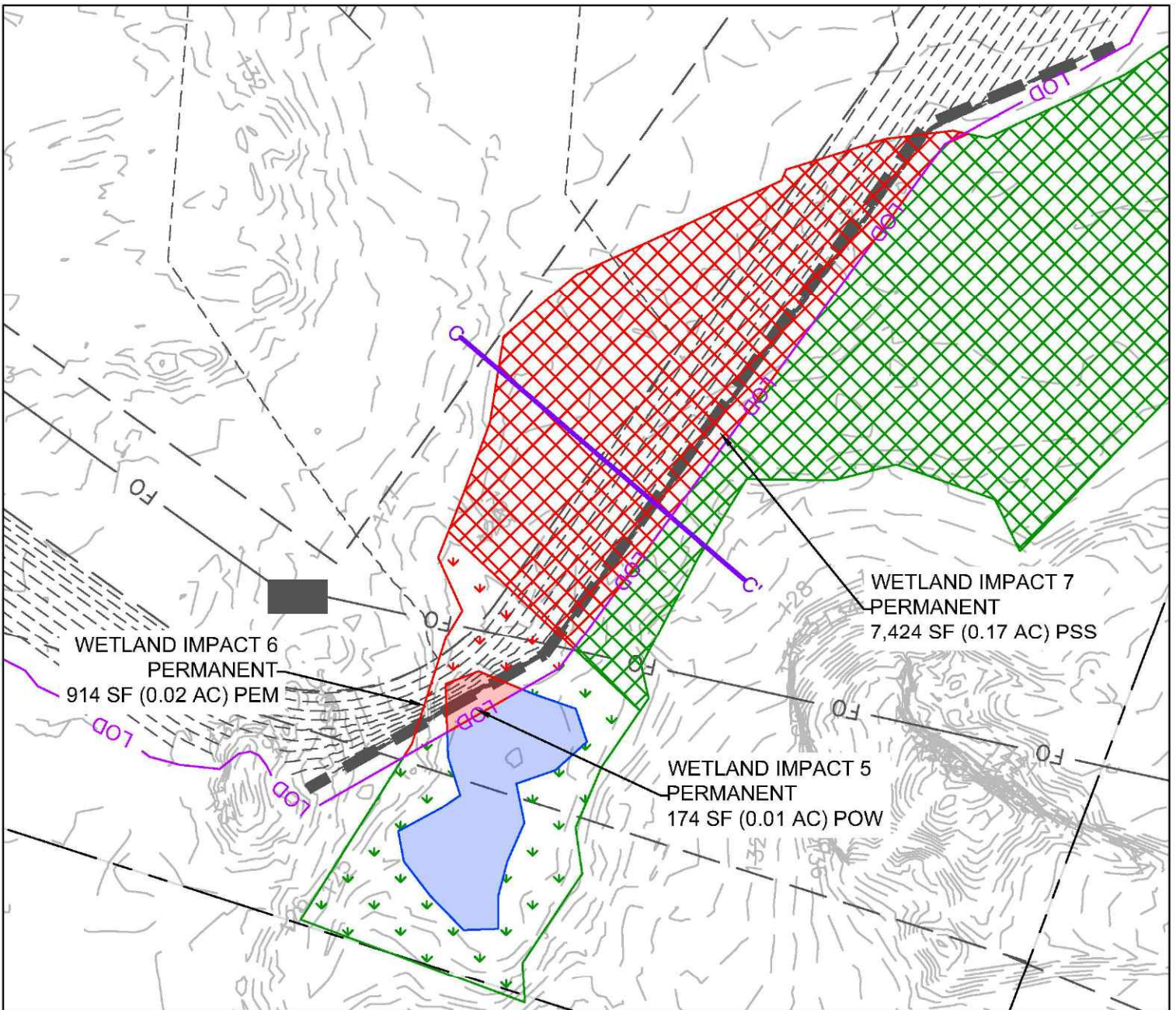

PERMIT APPLICATION
 POINTONE DATA CENTER
 CAMPUS
 CHARLES CITY COUNTY,
 VIRGINIA
 SEPTEMBER 2025



1340 CHARWOOD ROAD, SUITE B
 HANOVER, MARYLAND 21076
 410-859-4300

PLAN VIEW
 WETLAND IMPACTS 5, 6,
 AND 7
 WATERS OF THE U.S.
 ECS PROJECT NO.
 47:19067-F

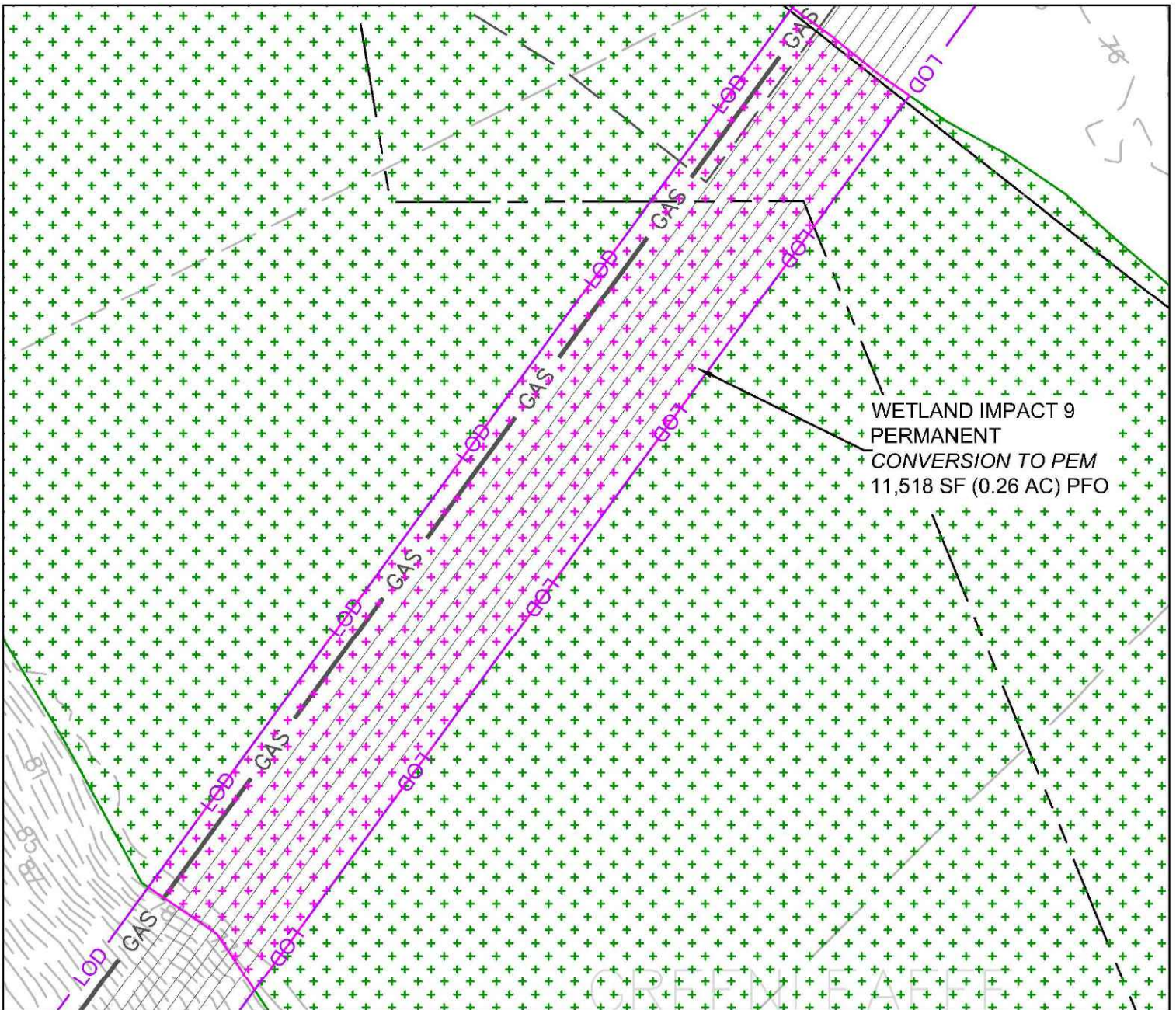

WETLAND IMPACT 9
 PERMANENT
 CONVERSION TO PEM
 11,518 SF (0.26 AC) PFO

SCALE (IN FEET)

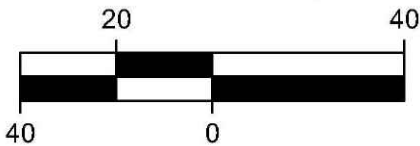

PERMIT APPLICATION
 POINTONE DATA CENTER
 CAMPUS
 CHARLES CITY COUNTY,
 VIRGINIA
 SEPTEMBER 2025



1340 CHARWOOD ROAD, SUITE B
 HANOVER, MARYLAND 21076
 410-859-4300

PLAN VIEW
 WETLAND IMPACT 9
 WATERS OF THE U.S.

ECS PROJECT NO.
 47:19067-F

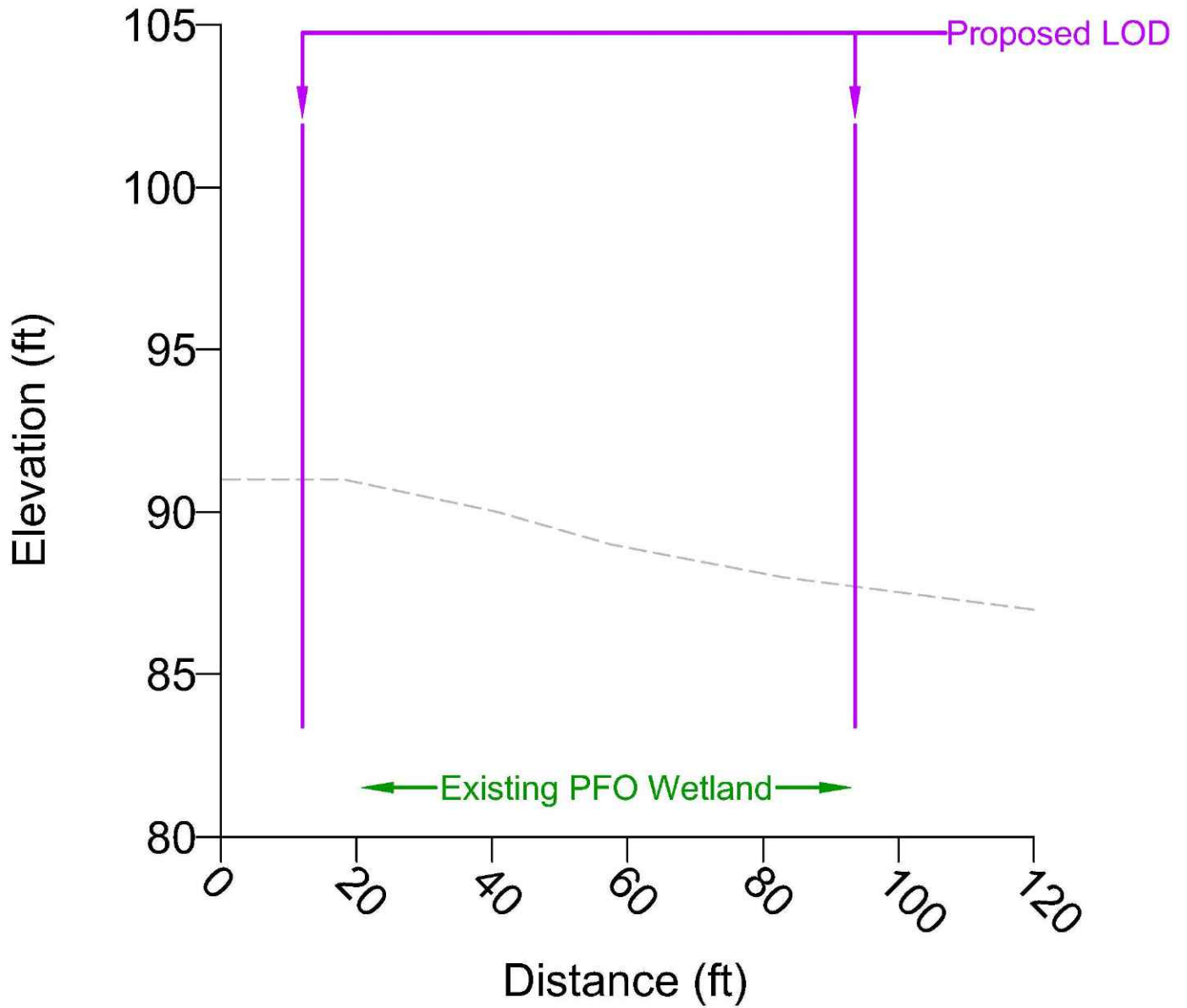

----- EXISTING ELEVATION CONTOURS

*A PRECAST CONCRETE BRIDGE SPAN IS PROPOSED AT THIS LOCATION. NO CHANGE IN SURFACE ELEVATION IS PROPOSED ALONG THIS CROSS SECTION.

PERMIT APPLICATION
 POINTONE DATA CENTER
 CAMPUS
 CHARLES CITY COUNTY,
 VIRGINIA
 SEPTEMBER 2025



1340 CHARWOOD ROAD, SUITE B
 HANOVER, MARYLAND 21076
 410-859-4300

CROSS SECTION
 A-A'
 WATERS OF THE U.S.
 ECS PROJECT NO.
 47:19067-F

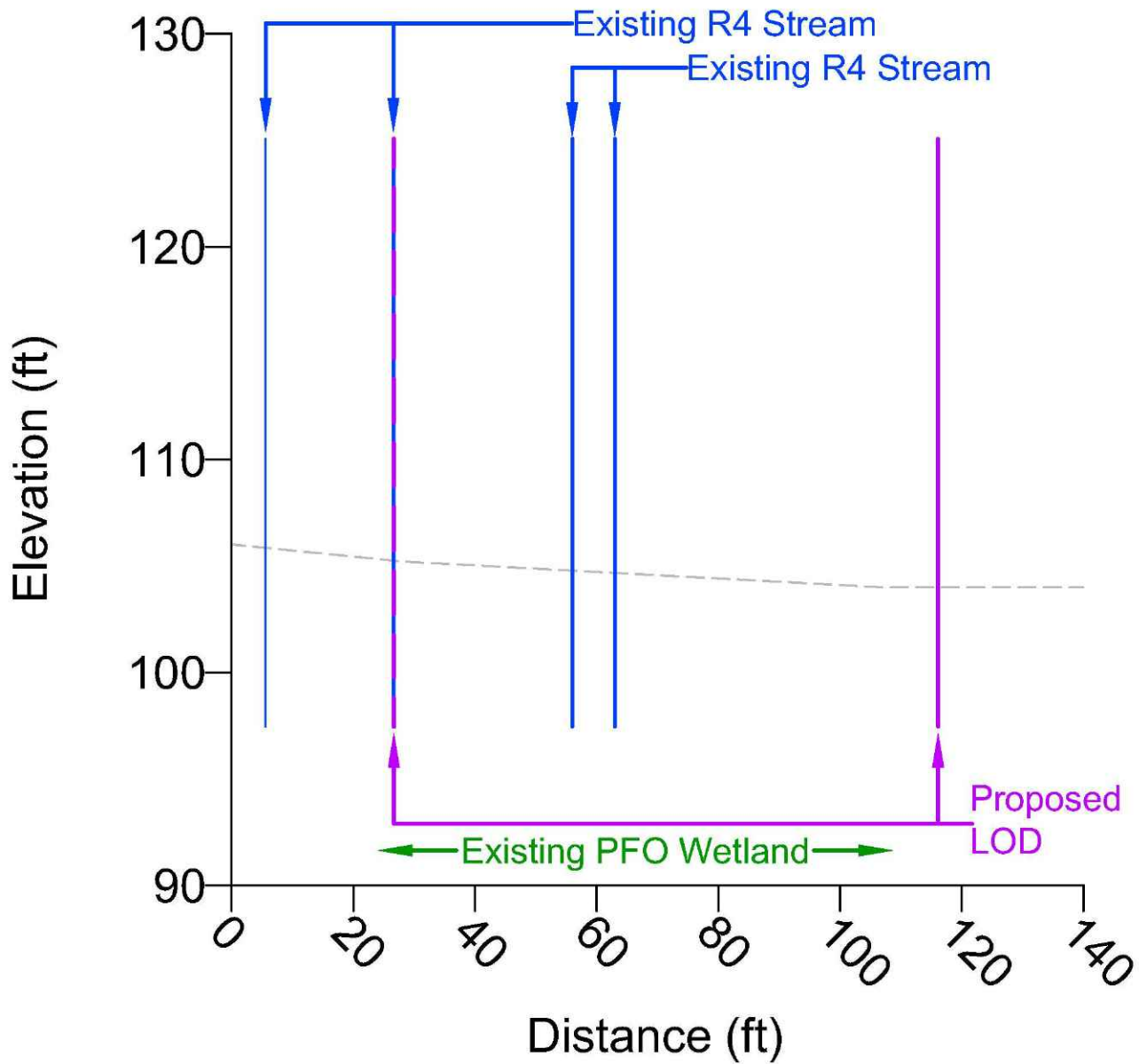

----- EXISTING ELEVATION CONTOURS

*A PRECAST CONCRETE BRIDGE SPAN IS PROPOSED AT THIS LOCATION. NO CHANGE IN SURFACE ELEVATION IS PROPOSED ALONG THIS CROSS SECTION.

PERMIT APPLICATION
 POINTONE DATA CENTER
 CAMPUS
 CHARLES CITY COUNTY,
 VIRGINIA
 SEPTEMBER 2025



1340 CHARWOOD ROAD, SUITE B
 HANOVER, MARYLAND 21076
 410-859-4300

CROSS SECTION
 B-B'
 WATERS OF THE U.S.
 ECS PROJECT NO.
 47:19067-F

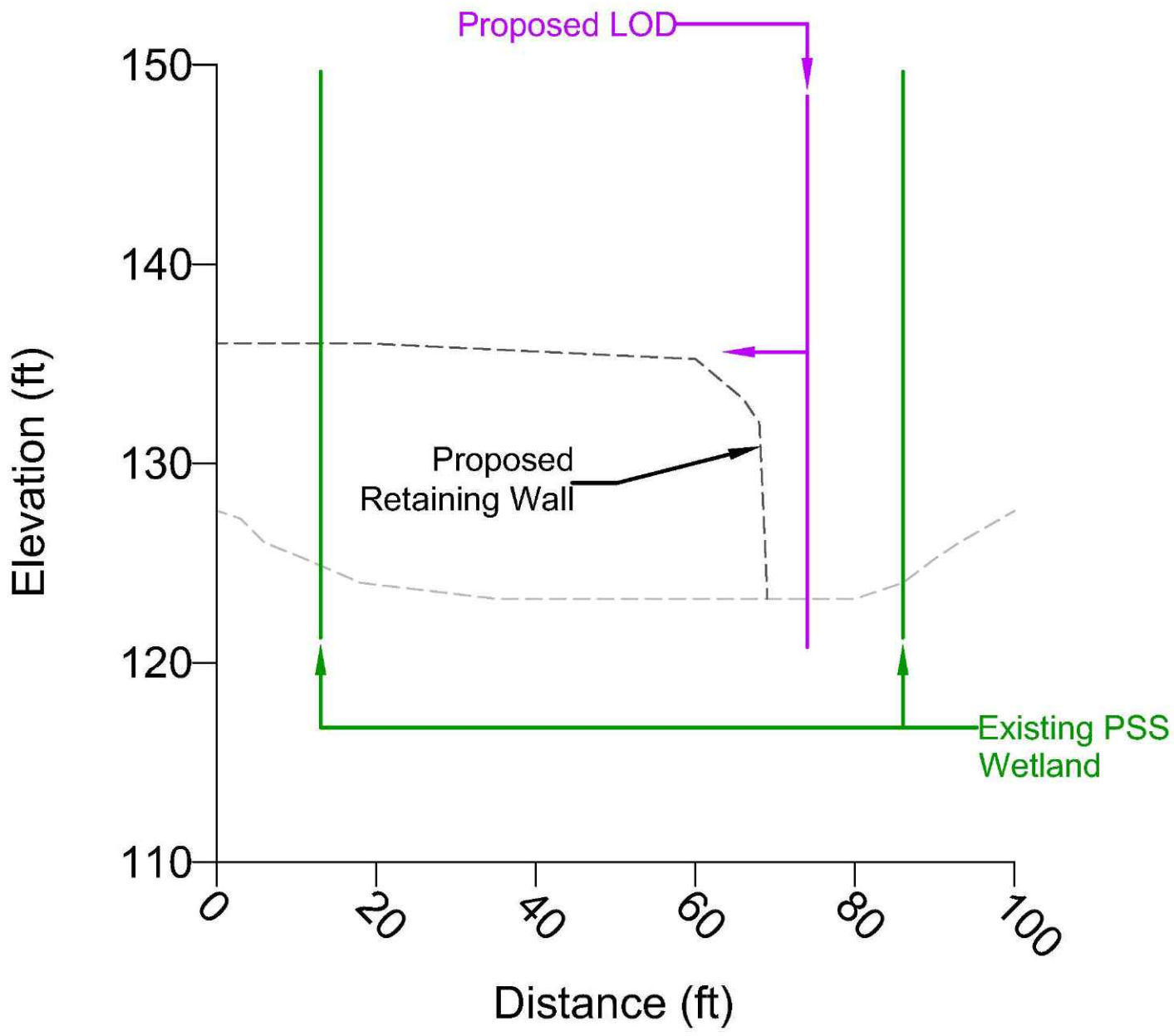

----- EXISTING ELEVATION CONTOURS
 ----- PROPOSED ELEVATION CONTOURS

PERMIT APPLICATION
 POINTONE DATA CENTER
 CAMPUS
 CHARLES CITY COUNTY,
 VIRGINIA
 SEPTEMBER 2025



1340 CHARWOOD ROAD, SUITE B
 HANOVER, MARYLAND 21076
 410-859-4300

CROSS SECTION
 C-C'
 WATERS OF THE U.S.
 ECS PROJECT NO.
 47:19067-F